

TUBE REMOVAL TOOLS

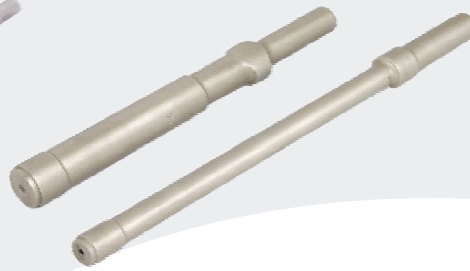

TUBE WALL REDUCER

■ HSS reamer with morse taper to fit in standard drill machine. Front end is suitably grounded as per tube gauge to facilitate reduction of tube thickness there by weakening expansion joint of tube for it removal.



TUBE DRIFT/KNOCKOUT TOOL

■ Build from high impact steel for knocking out tube from tube sheet with pneumatic hammer. Front end machined as per tube gauge for correct alignment of tool there by facilitating removal of tube without damaging tube sheet.



COLLAPSING TOOL

■ Used for collapsing the non-ferrous tubes or ferrous tube made thinner using tube wall reduce for driving the tube out of tube sheet. Preferably to be use with pneumatic hammer.

SPECIFICATIONS

Tube O.D. inch	Model Number	MT Shank #
3/8	WR-375	1
1/2	WR-500	2
5/8	WR-625	2
3/4	WR-750	2
7/8	WR-875	2
1	WR-1000	3
1.1/4	WR-1250	3
1.1/2	WR-1500	3
1.3/4	WR-1750	3
2	WR-2000	3
2.1/2	WR-2500	4
2.3/4	WR-2750	4
3	WR-3000	4
3.1/4	WR-3250	4
3.1/2	WR-3500	4
4	WR-4000	4

Tube O.D. inch	Model Number
3/8	KT-375
1/2	KT-500
5/8	KT-625
3/4	KT-750
7/8	KT-875
1	KT-1000
1.1/4	KT-1250
1.1/2	KT-1500
1.3/4	KT-1750
2	KT-2000
2.1/2	KT-2500
2.3/4	KT-2750
3	KT-3000
3.1/4	KT-3250
3.1/2	KT-3500
4	KT-4000

Tube O.D. inch	Model Number
3/8	CT-375
1/2	CT-500
5/8	CT-625
3/4	CT-750
7/8	CT-875
1	CT-1000
1.1/4	CT-1250
1.1/2	CT-1500
1.3/4	CT-1750
2	CT-2000
2.1/2	CT-2500



Chipping Hammer with safety retainer for use with Tube Drifts / Collapsing Tools.

MODEL CH-1 - SPECIFICATION

Blows/min	Bore	Stroke	Weight
1600	1.1/8" (28.5 mm)	3.1/4" (82.5mm)	16 lbs (7.0 kg)